



FILTER CLEANING LGH-RVX MODELS

Remove all dust and dirt on air filters and Lossnay cores at regular intervals in order to prevent a deterioration in the Lossnay functions.

Guideline: Clean the air filters once a year.
(or when are indicated on the remote controller)

Clean the Lossnay cores once two year.
(Clean the Lossnay cores once a year if possible.)
(Frequency should be increased depending on the extent of dirt.)

Removing the parts

1) Maintenance cover

1. Remove the black screw.
2. Slide the fix piece to out side.
3. Open hinge wire.

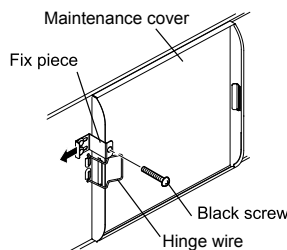

Models LGH-150 and 200RVX-E have 2 fix pieces.

2) Lossnay cores

Take hold of the handle and draw the Lossnay cores out from the main unit.

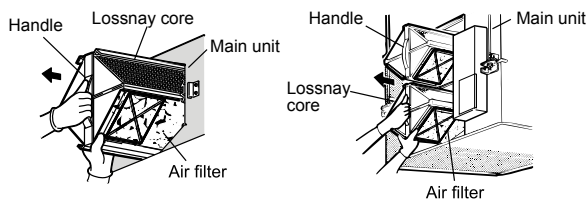

Models LGH-15 to 100RVX-E Models LGH-150 and 200RVX-E

2) Lossnay cores

Use a vacuum cleaner to suck up the dust and dirt on the exposed surfaces of the Lossnay cores.

Use a soft brush only to clean exposed surface areas.

Do NOT wash in water.

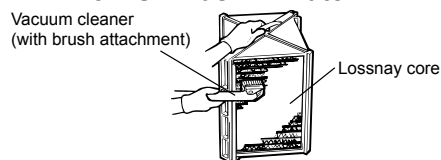

CAUTION

- Do not use the hard nozzle of the vacuum cleaner. It may damage the exposed surfaces of the Lossnay cores.
- Under no circumstances should the Lossnay cores be washed in water.

3) Air filters

After pulling out the Lossnay cores, undo filter guides, then remove the air filters, located at the bottom left and right of the Lossnay cores, as below.

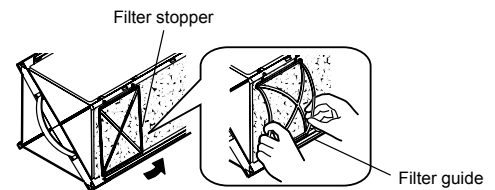

Model LGH-15RVX-E: 1 core, 2 filters
Models LGH-25 to 100RVX-E: 2 cores, 4 filters
Models LGH-150 and 200RVX-E: 4 cores, 8 filters

CAUTION

- Bow filter stoppers a little to remove them from filter guide.
- Take filter stoppers careful not to break them.

Cleaning the parts

1) Air filters

Use a vacuum cleaner to remove light dust. To remove stubborn dirt wash in a mild solution of detergent and lukewarm water. (under 40°C)

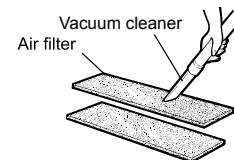

CAUTION

- Never wash the filters in very hot water and never wash them by rubbing them.
- Do not dry the filters by exposing them to a flame.

Complete Filter replacement for standard filters is 2 years maintenance cycle
While for the High efficiency filter that are used on OA section is every 1 year maintenance cycle

Assembly after maintenance

Bearing in mind the following points, assemble the parts following the sequence for their removal in reverse.

- Arrange the Lossnay core with the air filter side downward.
- The filter for LGH-15 and 35RVX-E has front and back side. Set the "FRONT" (printed) side of the filter on the outer side.

Note

- If are indicated or the remote controller, turn off the indication, after maintenance.

Cleaning the core is only recommended every 2 years / if found dirty.

For more information please contact our Technical Support Team on 0800 737 842